



Dry and Damp locations

The Cesta family includes its wall versions, Wally Cestita and Wally Cesta, characterised by the globe as a light diffuser and a metallic structure available in black or white. Wally Cesta is the recent incorporation that comes in larger dimensions created to adapt larger spaces and outdoor

General description:

Metallic structure finished in black or matte white.
White opal polyethylene lampshade.
Suitable for Outlet Box (UL market).

Approximate weight (unpacked):

2,78 kg / 6.78 lb

Technical information:

Light source included (CE market):
LED bulb: 12 W / 1.521 lm / 2700K / A++ (subject to updates in LED technology).
E27 - E26 / Max. hgt. 130 mm / 5.1"

Compatible with bulbs of the Energy efficiency class (E.E.C): A++... E.
Suitable for indoor and outdoor use.
Always use the light source recommended or equivalent.

Input voltage: 100, 120, 230 Vac.
(50 Hz / 60 Hz). According to destination

Regulations:

CE
UNE-EN 60598
UNE-EN 55015
UNE-EN 60529

UL
Dry and damp location
UL-1598
E-353545

Maintenance:

Clean with a smooth cloth. Do not use ammonia, solvents or abrasive cleaning products.

Others:

The lamp is delivered in one package.
The assembly instructions are delivered with the product.

Modelo:

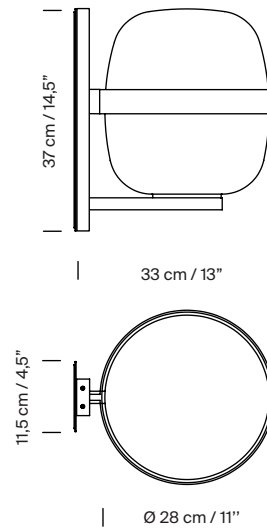
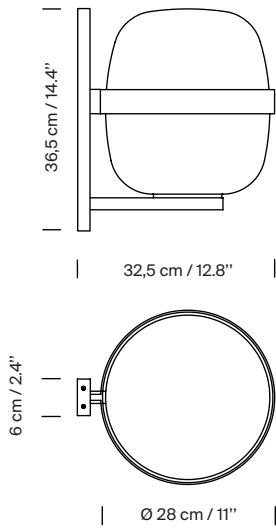

Collection:
Table lamps



Cesta



Cestita



Cesta Batería



Cesta Metálica



Cestita Metálica

Pendant lamps



Globo Cesta



Globo Cestita

Wall lamps (Outdoor)



Wally Cesta



Wally Cestita

Outdoor lamps



Cesta exterior



Cestita Alubat

Wally Cestita

Miguel Milá. 1962
Wall lamp



Strolling through Barcelona in the 1960s, designer Miguel Milá found an abandoned opal globe in front of a glass factory. He picked it up, and over the years, it became the heart of this large family. As its name suggests, Cesta (Spanish for “basket”), was designed to hold this fragile piece.

Designed in the same year as the Cesta lamps, Wally Cestita is an iconic wall lamp that shares the same opal globe shape and formal elegance. The structure, available in matt white or dark bronze finishes, is fixed to the wall via a metal arm and ring that wrap around and support the glass shade.

The Wally wall lamp adds a distinguishing touch to any setting. It provides a diffuse and soft illumination for both indoor and outdoor spaces.

General description:

Metallic structure finished in black or matte white.
White opal glass lampshade.
Suitable for Outlet Box (UL market).

Approximate weight (unpacked):

1,5 Kg / 3.3 lb

Technical information:

Light source included (CE market):
LED bulb: 4,5 W / 470 lm / 2700K / A++ (subject to updates in LED technology).
E27 - E26 / Max. hgt. 105 mm / 4.1” / Max. power 40 W

Compatible with bulbs of the Energy efficiency class (E.E.C): A++ ... E.
Suitable for indoor and outdoor use.
Always use the light source recommended or equivalent.

Input voltage: 100, 120, 230 Vac.
(50 Hz / 60 Hz). According to destination

Regulations:

CE
UNE-EN 60598
UNE-EN 55015
UNE-EN 60529

UL
Dry and damp location
UL-1598
E-353545

Maintenance:

Clean with a smooth cloth. Do not use ammonia, solvents or abrasive cleaning products.

Others:

The lamp is delivered in one package.
The assembly instructions are delivered with the product.

Model:

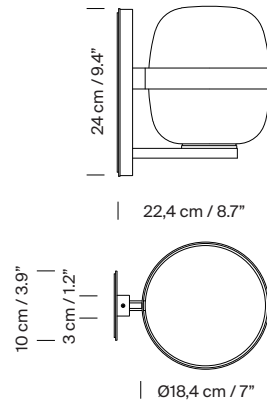
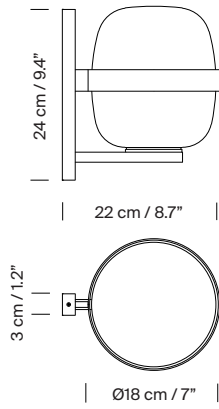

Collection:

Table lamps



Cesta



Cestita



Cesta Batería



Cesta Metálica



Cestita Metálica

Pendant lamps



Globo Cesta



Globo Cestita

Wall lamps (Outdoor)



Wally Cesta



Wally Cestita

Outdoor lamps



Cesta exterior



Cestita Alubat